

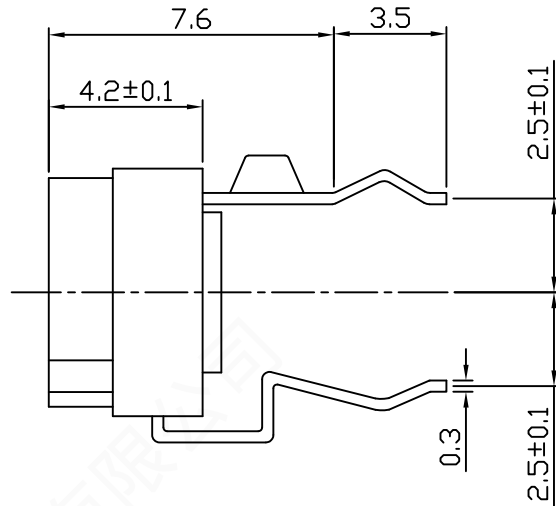

# 外形圖 Mechanical Dimensions

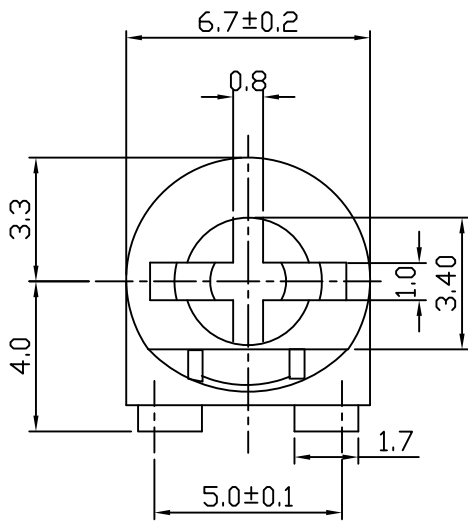

安裝孔位置圖  
Mounting Hole

接線圖  
Circuit Explanation

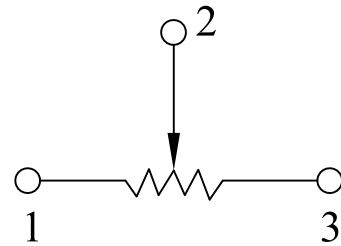
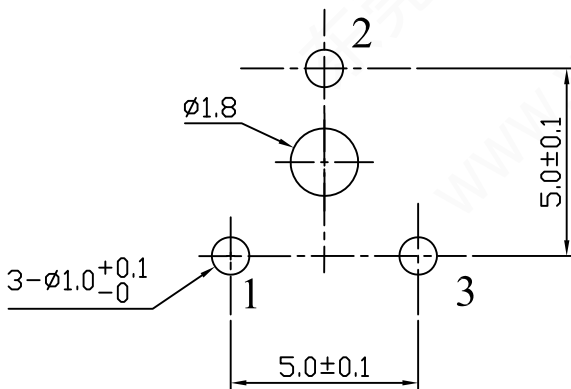

2				PRODUCT NAME	Semi-Fixed Potentiometers		
1				MODEL NAME	<b>SM065B-</b>		
NO	DATE	DESCRIPTION		APPROVED BY	CHECKED BY	DRAWN BY	
	$l \leq 10$	$\pm 0.2$	UNIT			<div style="border: 2px solid red; border-radius: 50%; padding: 5px; display: inline-block;"> R &amp; D  2012.03.20  Lisa </div>	
	$10 < l \leq 30$	$\pm 0.5$	VER.				
	$30 < l \leq 100$	$\pm 1.0$	DATE	2008/06/08			



# 一、微調電阻系列技術規格書

Common Specification For Semi-Fixed Potentiometers

1. 電器性能 (Electrical Characteristic)				
序号	項目			特性
1.1	全阻抗值 (Total Resistance)			100 Ω ~ 2M Ω
1.2	全阻抗值允許偏差 (Total Resistance Tolerance)			± 20%
1.3	電阻隨溫度變化特性 (Resistance of temperature change character)			20℃-75℃ : $\Delta R/R \leq \pm 5\%$ , -25℃-20℃ : $\Delta R/R \leq \pm 4.5\%$
1.4	阻值變化特性 (Resistance Taper)			B
1.5	零位阻值 (Residual Resistance)			$R \leq 10K$ 10 Ω Max $R > 10K$ 1% Max.
1.6	額定功率 (Rated Power)			Carbon Film Type 0.1W
1.7	最高使用電壓 (Max. Operating Voltage)			AC 50V
1.8	動雜音 (Rotational Noise)			Less Than 150mV
1.9	工作溫度 (Operation Temperature)			-25℃ ~ 85℃
2. 機械性能 (Mechanical Characteristics)				
2.1	全回轉角度 (Rotation Angle)			210° ± 10°
2.2	旋轉力矩 (Rotation Torque)			20 ~ 200gf. cm
2.3	轉動止檔強度 (Rotational Stop-End Torque)			0.5kgf. cm. max
2.4	焊錫耐熱性 (Resistance to soldering heat)			260 ± 5℃ and less than 3 seconds
3. 耐久性能 (Durability)				
3.1	回轉壽命 (Rotation Life)			100 cycles min
4. 外形尺寸圖/曲線特性圖 (Shape size drawing/curve characteristic drawing)				見附頁 (Please see attachment)
5				
批 准		審 核		設 計



東莞市雅弧電子有限公司  
DongGuan YaHu Electronic Co.,Ltd.

# RESISTANCE TAPER



OUTPUT VOLT.ACROSS TERMINAL 1,2  
INPUT VOLT.ACROSS TERMINAL 1,3 x100%

### TAPER B SERIES

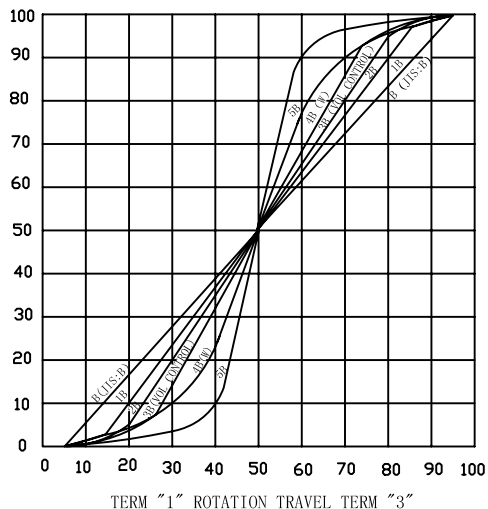

OUTPUT VOLT.ACROSS TERMINAL 1,2  
INPUT VOLT.ACROSS TERMINAL 1,3 x100%

### TAPER B WITH 50% TAP

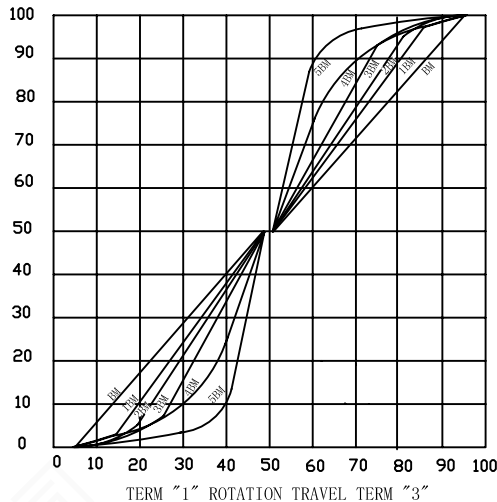

OUTPUT VOLT.ACROSS TERMINAL 1,2  
INPUT VOLT.ACROSS TERMINAL 1,3 x100%

### TAPER A SERIES

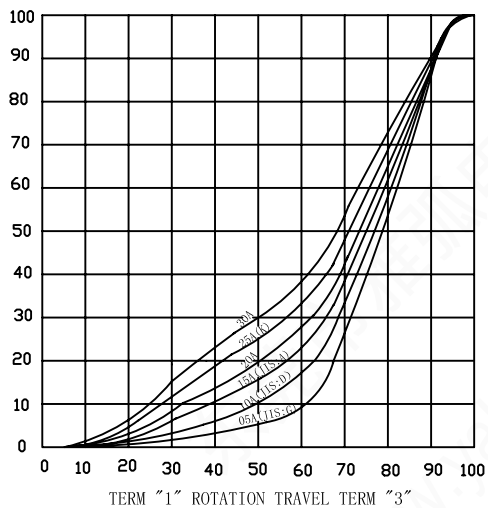

OUTPUT VOLT.ACROSS TERMINAL 1,2  
INPUT VOLT.ACROSS TERMINAL 1,3 x100%

### TAPER A & C WITH 50% TAP

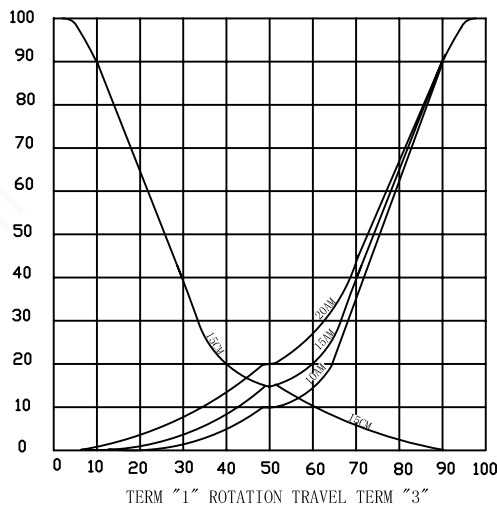

OUTPUT VOLT.ACROSS TERMINAL 1,2  
INPUT VOLT.ACROSS TERMINAL 1,3 x100%

### TAPER C SERIES

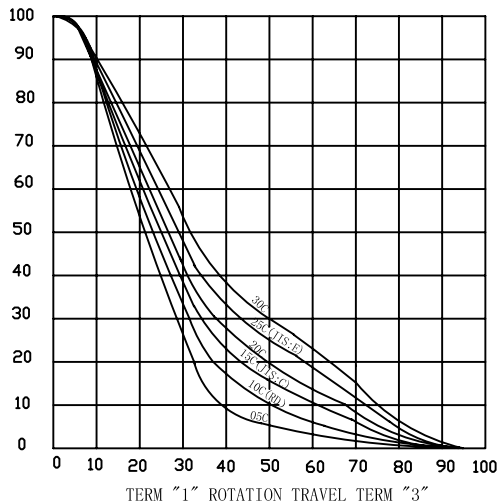

M  
OUTPUT VOLT.ACROSS TERMINAL 1,2  
INPUT VOLT.ACROSS TERMINAL 1,3 x100%

N  
OUTPUT VOLT.ACROSS TERMINAL 1,2  
INPUT VOLT.ACROSS TERMINAL 1,3 x100%

### TAPER M & N SERIES

